



Graduation Day Celebrations

July 2024

Congratulations!

We're really looking forward to celebrating with you this July. Here's some useful information to help you plan your day.

Further details are available on our Graduation website.

Information for those graduating

- Arrive on campus 2 hours before your ceremony.
- Collect your gown from the LICA Building.
- Plan in time to have your individual and family photographs taken in the LICA Building.
- Make your way to the Great Hall 1 hour before your ceremony. You will then be seated by our ushers.
- **It's really important that you arrive at the Great Hall, wearing your gown, 1 hour before your ceremony start time.**
- Once the ceremony has ended, please remain seated. You'll be guided out by ushers one row at a time.
- Find out more details about your ceremony at www.lancaster.ac.uk/graduation

Don't forget:

- Plan in a toilet stop before you are seated to avoid any additional movement around the Great Hall.
- Any personal items such as handbags and coats must either be left with your guests or checked into the Cloakroom located in The Roundhouse. Graduands themselves are not permitted to take these items into The Great Hall. No large luggage items are permitted within the Great Hall and must be stored at The Roundhouse.
- Remember, you will need your ticket QR code either on your phone or printed off with you to gain entry into the ceremony.

Information for guests

- Make your way to the Great Hall. It will open 1 hour before the ceremony.

You need to be seated 30 minutes before the beginning of the ceremony.

- Ushers will guide you to your seat. It's really important that guests arrive as indicated above. Unfortunately, we cannot guarantee that latecomers will be admitted.
- Please be considerate of other guests during the ceremony.
- Children are welcome to attend the ceremonies, however we respectfully ask that they are taken outside if they become unsettled.
- You may take photographs but please stay seated so you do not obstruct the view of other guests.
- Filming on any device is not permitted in the Great Hall. The ceremonies will be available for replay on the Lancaster University YouTube channel.
- Once the ceremony has ended, please remain seated. You'll be guided out by ushers one row at a time.
- The ceremony lasts for approximately 1 hour and 15 minutes.
- Except guide dogs, no other dogs or pets are allowed on campus.
- Due to fire and safety regulations, pushchairs are not allowed in the Great Hall but they can be left in the Great Hall Foyer in a dedicated area. Please visit the ticket office on the day for more information.

Don't forget:

- Plan in a toilet stop before you are seated to avoid any additional movement around the Great Hall.

Live ceremony screenings

- Guests without Great Hall tickets can watch the ceremony screened live in the Margaret Fell Lecture Theatre.
- You will need to have booked a ticket to access the venues.
- The atmosphere is informal and celebratory.
- The ceremony will also be broadcast to some College Bars, and the big screen in Alexandra Square.



Refreshments

A variety of catering outlets are located across campus and some College Bars are open throughout the day.

Questions on the day?

- Check our [FAQs page](#) on our graduation website.
- Look out for our Graduation Assistants across campus (they'll be wearing red t-shirts).
- Visit the Ticket Office in the Great Hall.
- Ask a member of the Graduation Team in the Great Hall (they'll be wearing grey gowns).

Guest WIFI

WIFI is free on campus for guests. Look for LU-Visitor in your list of Wi-Fi networks.

Photography

- Go to the LICA Building for your individual and family photography.



Getting here and arrival

Our location

3 miles south of Lancaster City Centre.
Graduation parking postcode: LA1 4WA

By rail

Direct rail links operate from around the UK to Lancaster Station including from Manchester Airport. Take the number 4 bus direct from outside the station to campus.

By bus

Frequent buses operate between Lancaster City Centre, Preston, Galgate and the University underpass, download the iLancaster App for more information.

By taxi

Taxis can drop off by the Chaplaincy Centre.

By road from the motorway

Leave M6 motorway at junction 33. Take A6 north towards Lancaster and follow signs for graduation parking.

By road from A6 Southbound/city centre

Take 2nd left after main University entrance. Enter the campus at Alexandra Park entrance and follow signs for graduation parking.

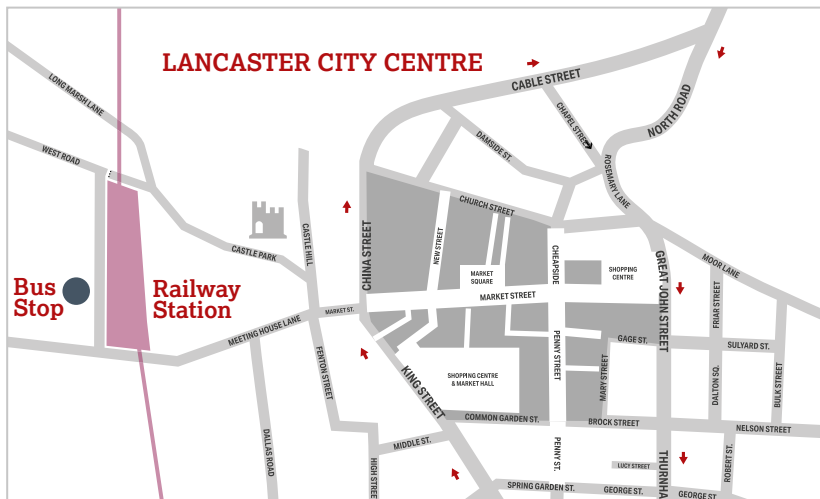

Parking

From 9am parking may be limited, please arrive early, or consider taking public transport or a taxi to campus.

When you arrive, please follow parking marshals' instructions.

There are no parking charges on graduation day.

Shuttlebuses

A free shuttlebus service by Stagecoach will link North Campus (LICA, Great Hall) and South/South-West Campus parking areas.

You can also take any scheduled Stagecoach bus to and from the University underpass to on-campus bus stops for free.

Overflow car park

If campus parking is full, you'll be directed to the overflow car park. You will need to either walk up the hill or catch a bus from the Sports Centre to the underpass.

Guests with limited mobility should be dropped off at the Chaplaincy Centre before parking in the overflow car park.

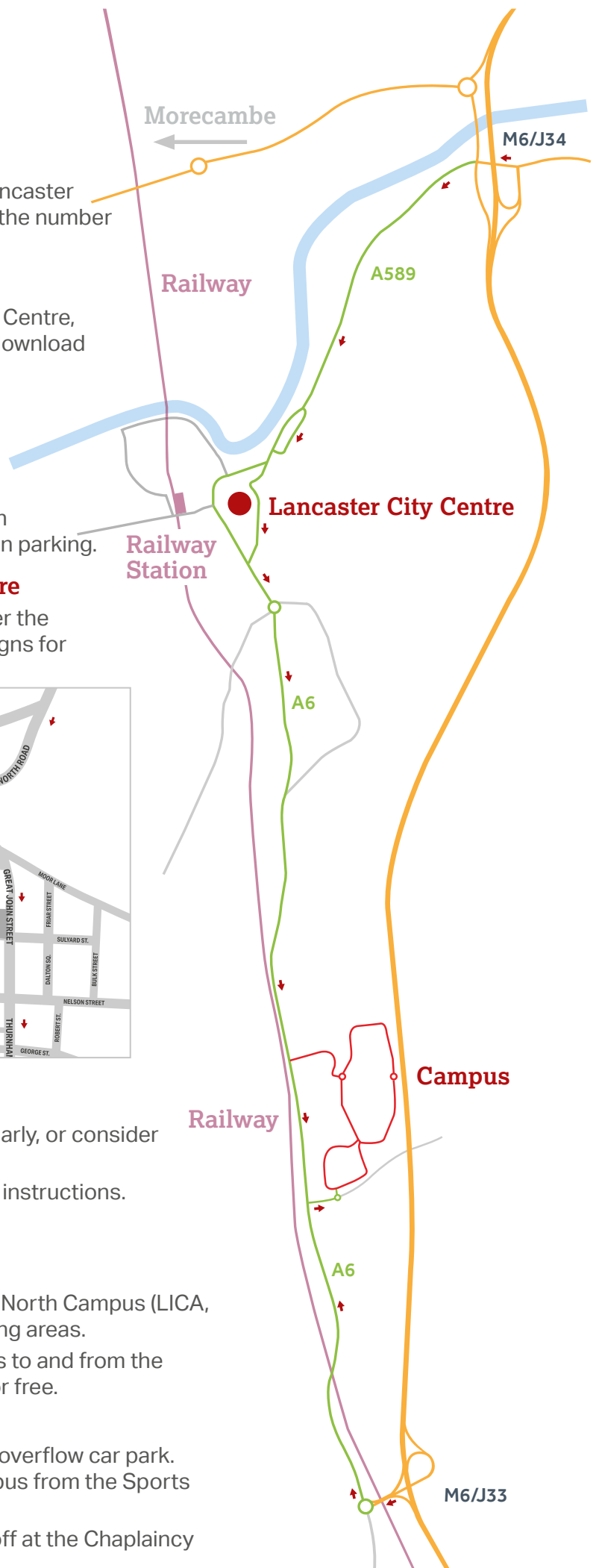

Key venues when you're here

LICA Building

- Gown collection – 11:45am to 7pm (Monday) and 08:30am to 7pm (Tuesday to Friday). Please see the Roundhouse for gown return. If you are graduating in one of the 10.30am ceremonies, you can collect your gown between 5pm and 6pm the day before.
- Individual and family photography studios.

Lancaster Square Marquee with the following services

- Café and bottle bar.
- College and ceremony photographs purchase and collection point.
- Graduate college and careers.
- Graduation viewing screen.
- Merchandise stand.

The Great Hall

- Graduation ceremonies.
- Ticket Office – open from 11:45am (Monday) and 8.30am (Tuesday-Friday).

Margaret Fell Lecture Theatre

- Live ceremony screenings.

Roundhouse / The Confucius Institute

- Cloakroom, left luggage and gown return. **Please return gowns by 7pm on the day of your ceremony.**
- Alumni stand - Collect your free Alumni t-shirt here!

Pick-up and drop-off area

- Area reserved for passenger drop-off/pick-up only and blue badge parking.

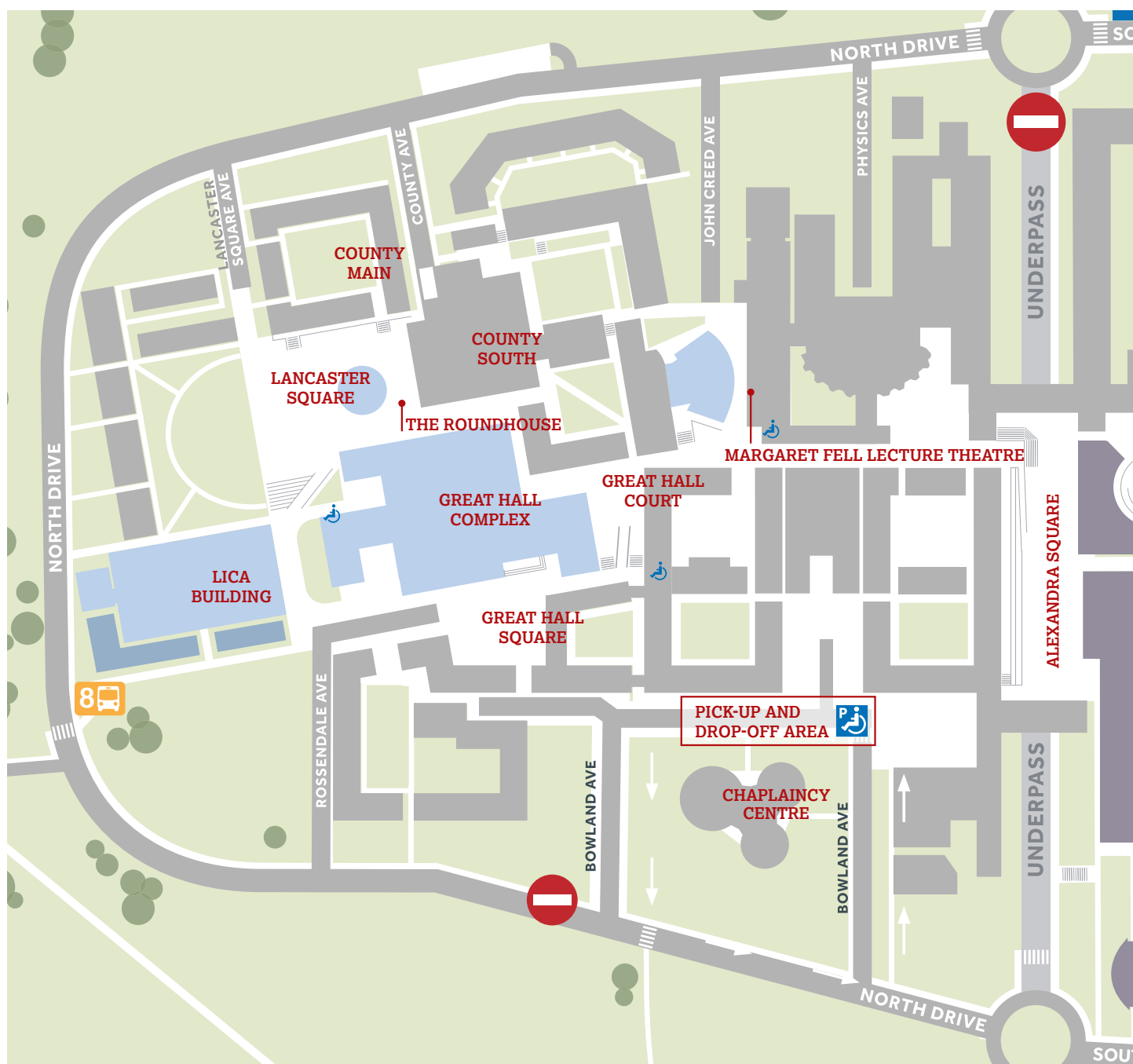

Great Hall Floorplan

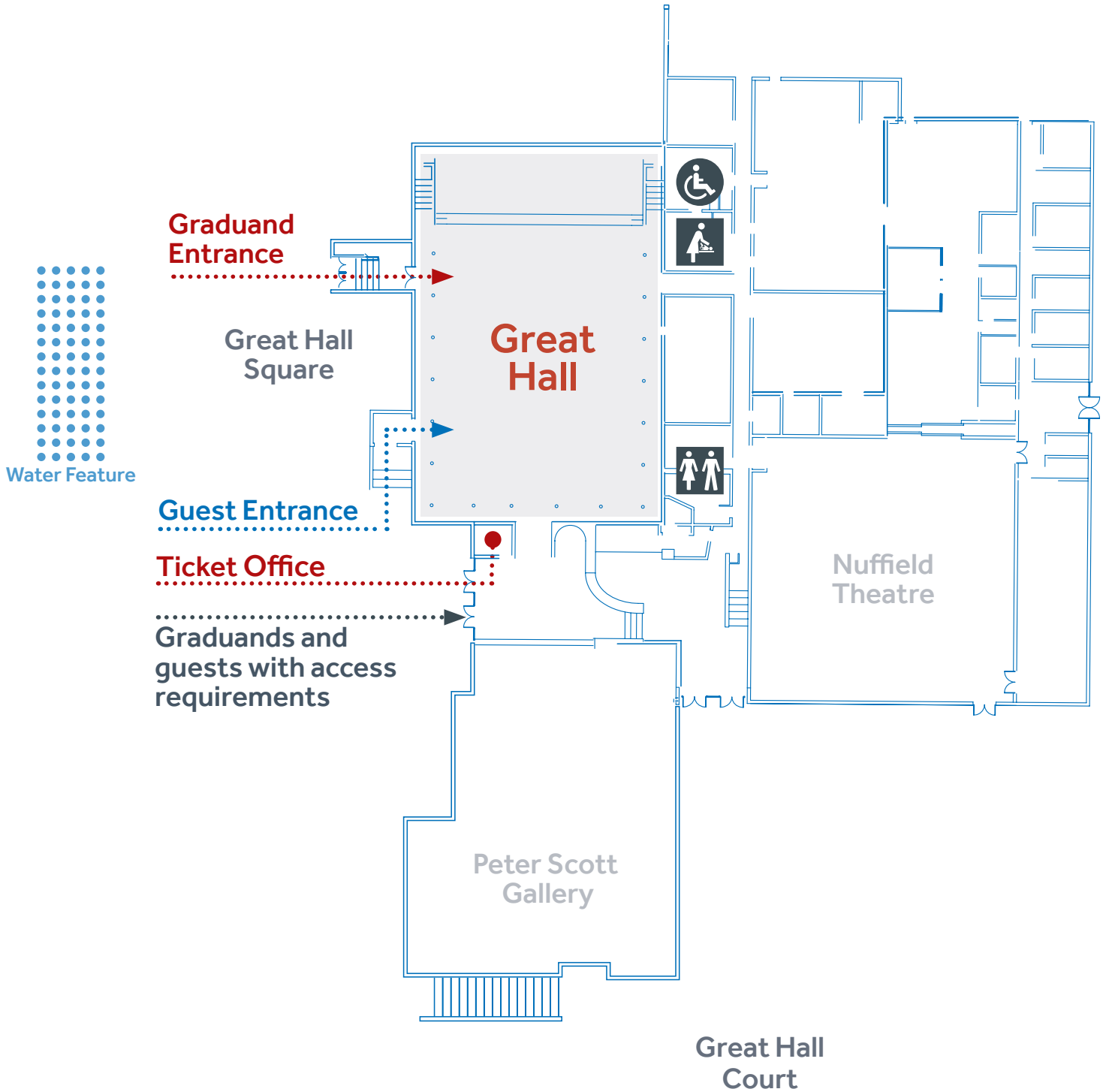



- ① Enter campus via one of these routes
- ② LICA Building
- ③ The Great Hall

- ④ Margaret Fell Lecture Theatre
- ⑤ The Confucius Institute (Roundhouse)
- ⑥ Pick-up and drop-off area

- P** Parking
-  Shuttlebus



MazeMap
Navigate around campus using our interactive map



iLancaster
Get our iLancaster app to help and enhance your visit to the University. Available to download for Apple and Android devices or to access on the web. Go to m.lancaster.ac.uk



Lancaster
University

